

# MAZDA CONNECT CMU SOFTWARE UPDATING PROCEDURE

## ONLY 2019 ~ Onwards for MAZDA Connect II

## ONLY 2019 ~ Onwards for MZD Connect II

### DESCRIPTION.....

- 1. Turn on ignition or ACC with push button start.
- 2. Press the volume mute button and keep pressing it.
- 3. Additionally, press Music and Favourite buttons at the same time for 3-5 seconds and the Diagnostic Test Screen will appear.

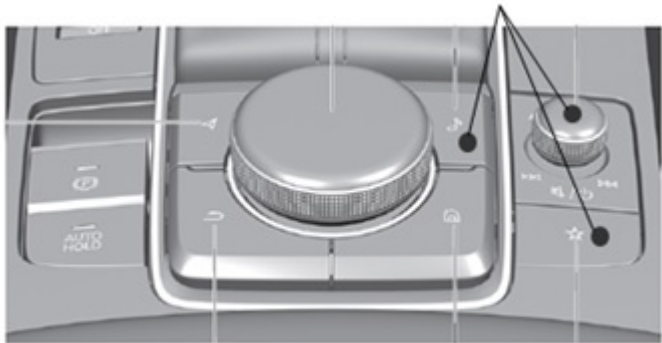

- 4. Select “Service Information” on the screen below.

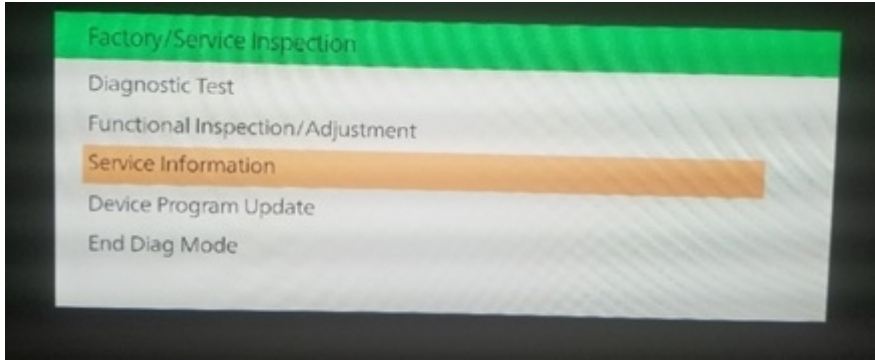

- 5. Select “Connected Device Information” on the screen below.

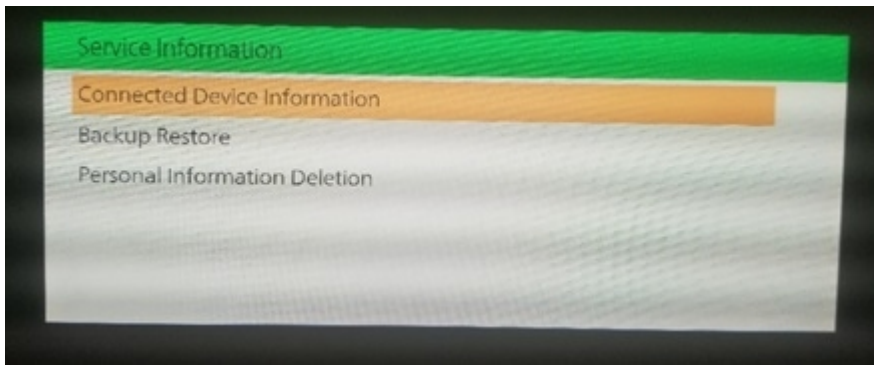

- 6. Select “CMU” on the screen below.

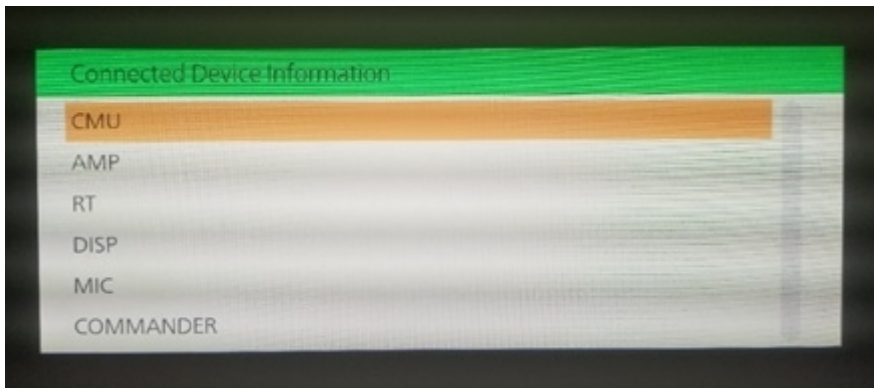

- 7. Check the CMU version in the second row of the list.  
**NOTE:** CMU software version “7000C0A-EU01\_\*\*\*\*\*” “7000C0A-4A01\_\*\*\*\*\*” for the EU and ADR market. Sample shows the CMU software for North America.

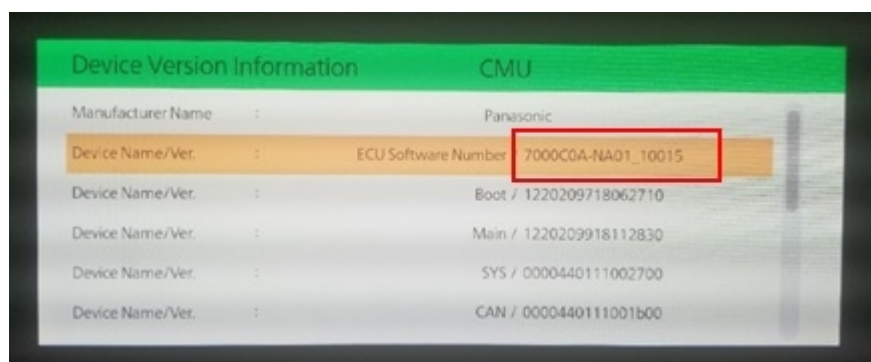

## 7G MAZDA CONNECT CMU SOFTWARE UPDATING PROCEDURE FOR EUROPE

1. Prepare an USB memory which contains the CMU software to be installed.

**NOTE 1:** It is not possible to install CMU software: 7000C0A-**EU**01\_\*\*\*\* to the vehicle whose CMU software is 7000C0A-**4A**01\_\*\*\*\* and vice versa.

**NOTE 2:** It is not possible to downgrade the software version. Only updating is available.

2. Remove the Navigation SD card from SD card slot of centre console.

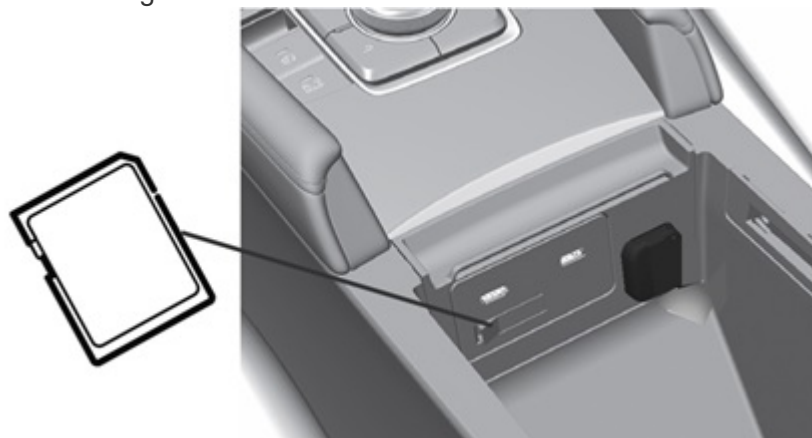

3. Turn on ACC or ignition with the push button start.

**NOTE:** Be careful that the battery runs out of charge since the function that automatically switching off the ACC is not equipped to the 7G Mazda Connect.

4. Insert the USB memory prepared at step 1 to the USB port.

**NOTE:** Both USB ports are available to insert the USB memory.

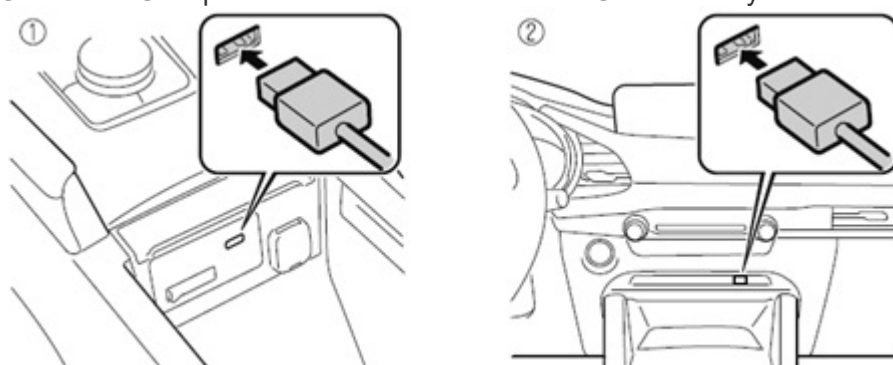

5. Press the volume mute button and keep pressing it.

6. Additionally, press Music and Favourite buttons at the same time for 3-5 seconds and the Diagnostic Test Screen will appear.

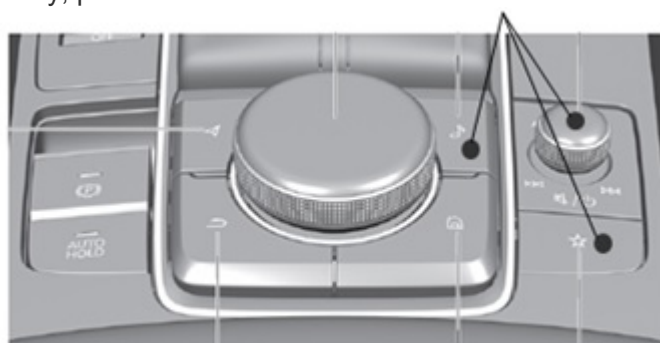

7. Select "Device Program Update" on the screen below.

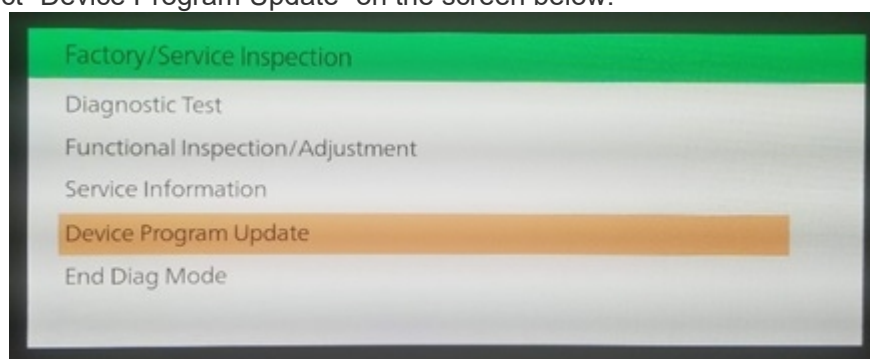

8. Select "System Update" on the screen below.

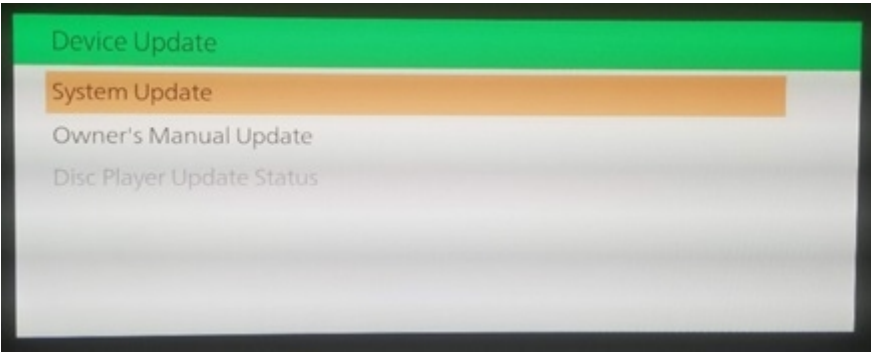

9. Select "USB" and checking for update file starts.

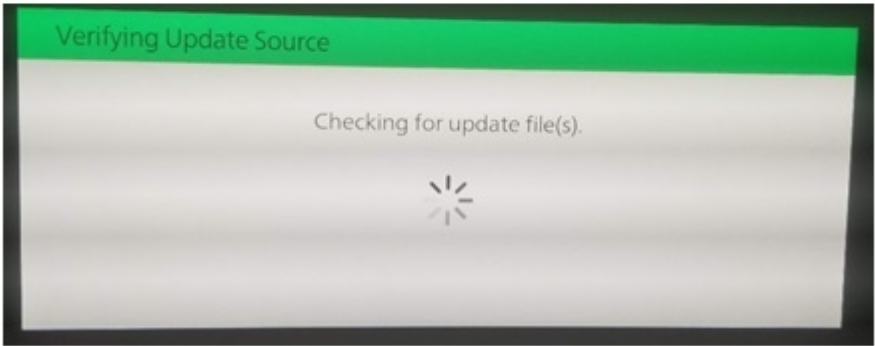
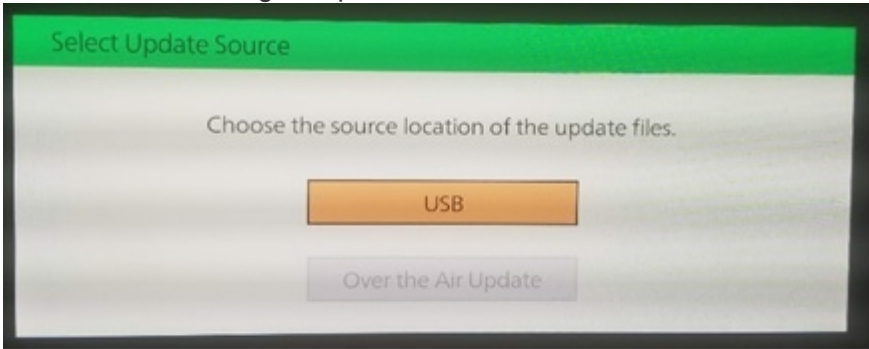

10. Select "CONNECTIVITY UNIT" on the screen below.

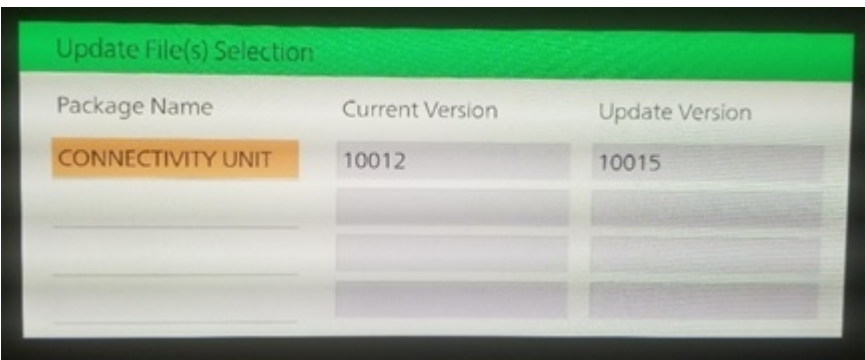

11. Select "OK" on the screen below and wait until the loading update is completed.  
**NOTE: Please DO NOT switch ignition or ACC OFF and remove the USB until all update files have been installed.**

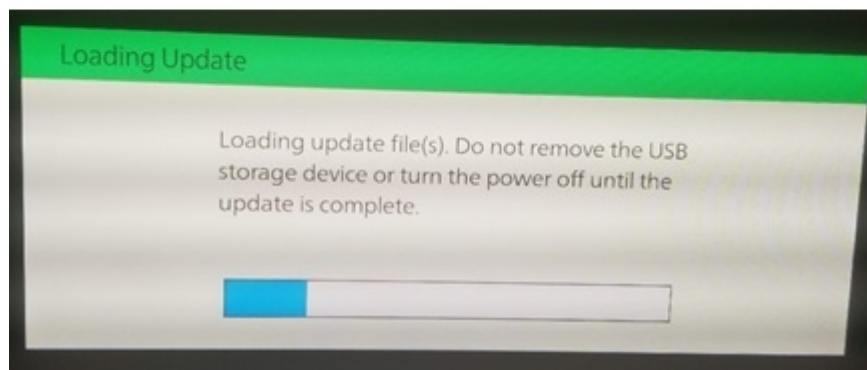
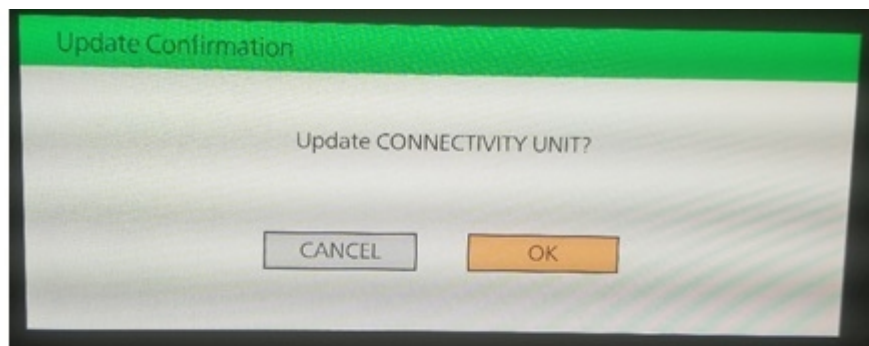

12. Select "OK" on the screen below.

**NOTE 1:** After selecting "OK", the system is rebooted and the display turns into black.

After that, "verifying update file" appears.

**NOTE 2:** Data update starts automatically after 10 seconds even if OK is not selected.

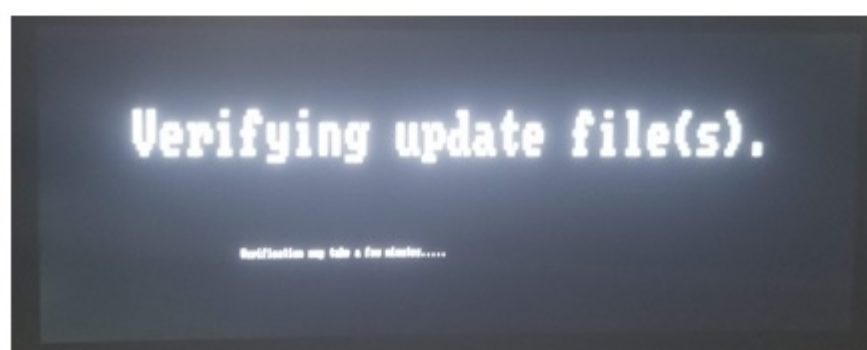
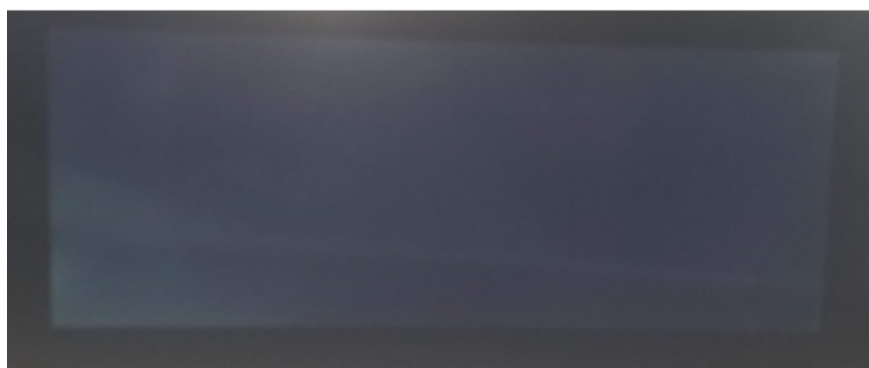
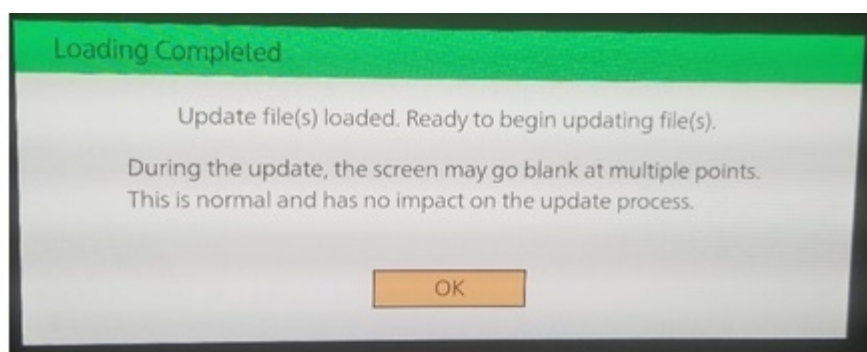

13. Wait until update is completed.

**NOTE:** The system reboots several times during updating.



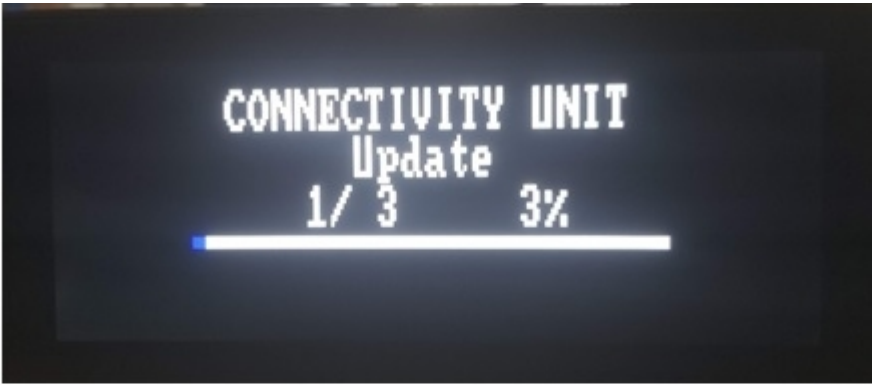

- 14. Remove the USB memory from the USB port.
- 15. Press the commander knob to reboot the system.
- 16. Check the CMU software version according to the above.
- 17. Switch ignition OFF and re-insert Navigation-SD card.

MICROPHONE CHECK AFTER FIRMWARE UPDATE

The shape of the switches differs depending on the vehicle model.

No.	Item	Explanation
1		Talk/Pick-up button: When the button is pressed, the voice recognition top screen is displayed and the voice recognition is activated.  (While voice guidance is being announced) Press the button to skip the voice guidance.
2		Hang-up button: Press the button to end the voice recognition.

- 1. Press 'Talk/Pick-up Button
- 2. Confirm that the voice recognition starts command "say a command" is played back.
- 3. If the command is not played back, please remove the car battery (Data-Reset). Check steps 1 and 2 again.

END PROCEDURE.